

# FORMAS CONSTRUTIVAS

PRA

PR

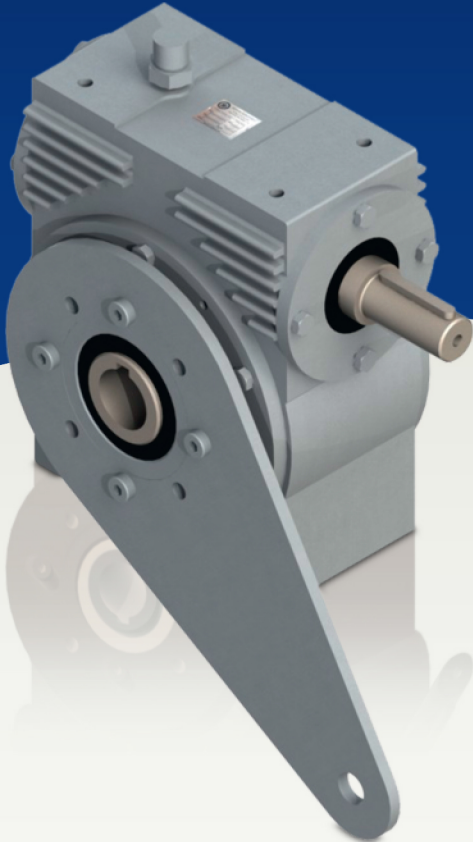

## FORMAS CONSTRUTIVAS PRA E PR

### EIXO DE SAÍDA NORMAL COM PÉ DO REDUTOR

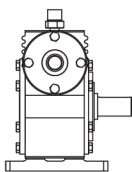
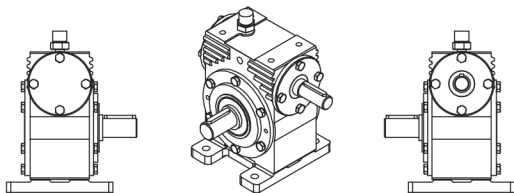

P101 D

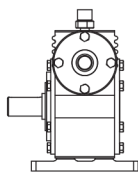

P101 E

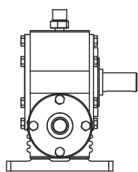

P102 D

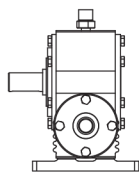

P102 E

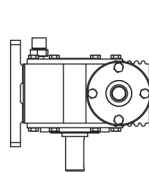

P103 D

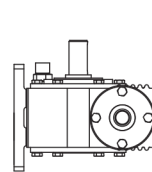

P103 E

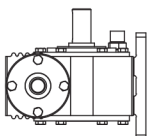

P104 D

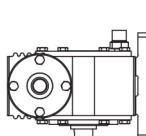

P104 E

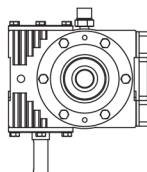

P105 D

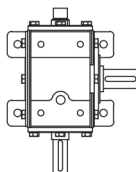

P105 E

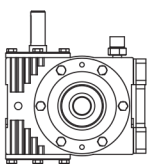
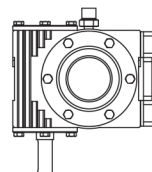

P106 D

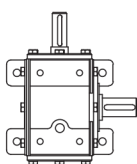

P106 E

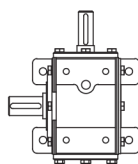
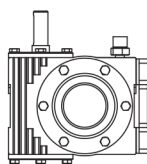

### EIXO DE SAÍDA DUPLO COM PÉ DO REDUTOR

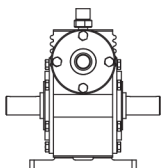
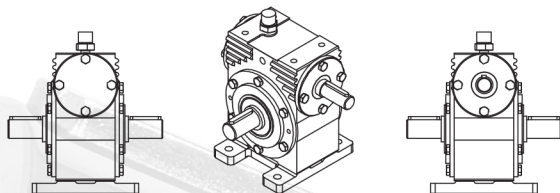

P101 DD

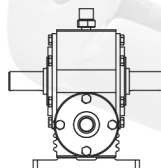

P102 DD

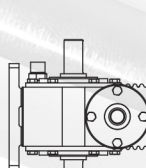

P103 DD

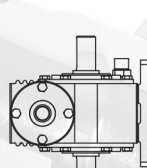

P104 DD

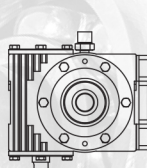

P105 DD

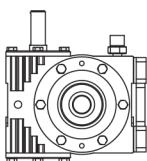
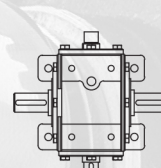

P106 DD

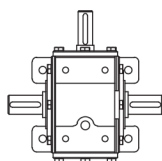

## FORMAS CONSTRUTIVAS PRA E PR

### EIXO DE SAÍDA VAZADO COM PÉ DO REDUTOR

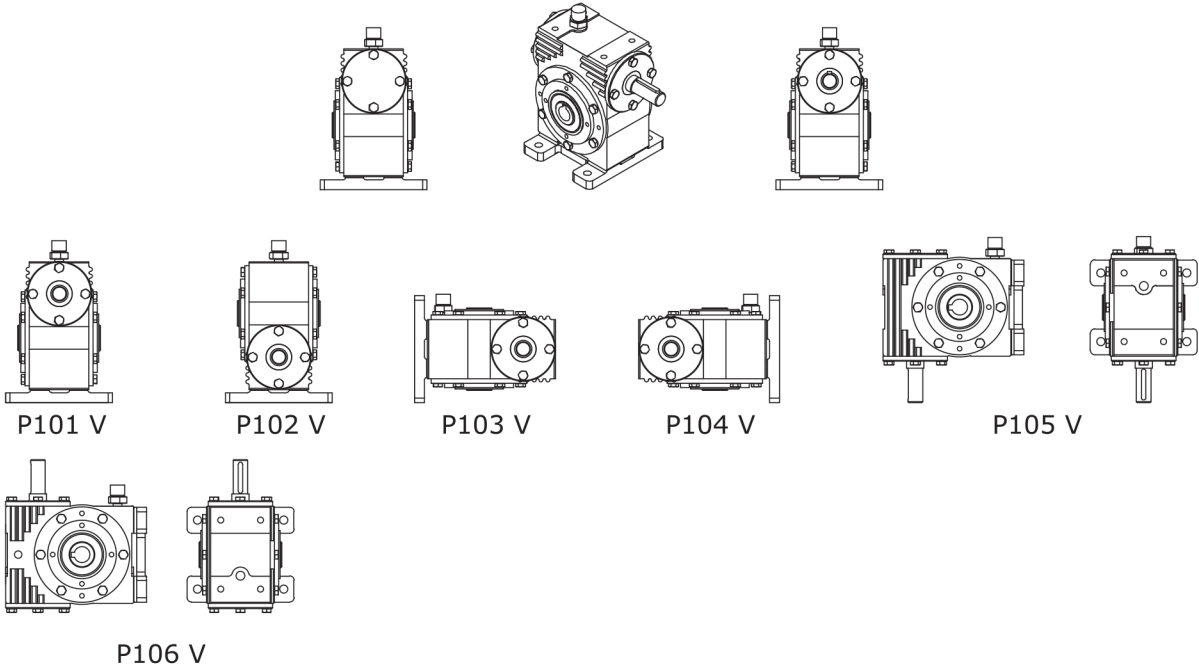

### EIXO DE SAÍDA VAZADO COM BRAÇO TORÇOR

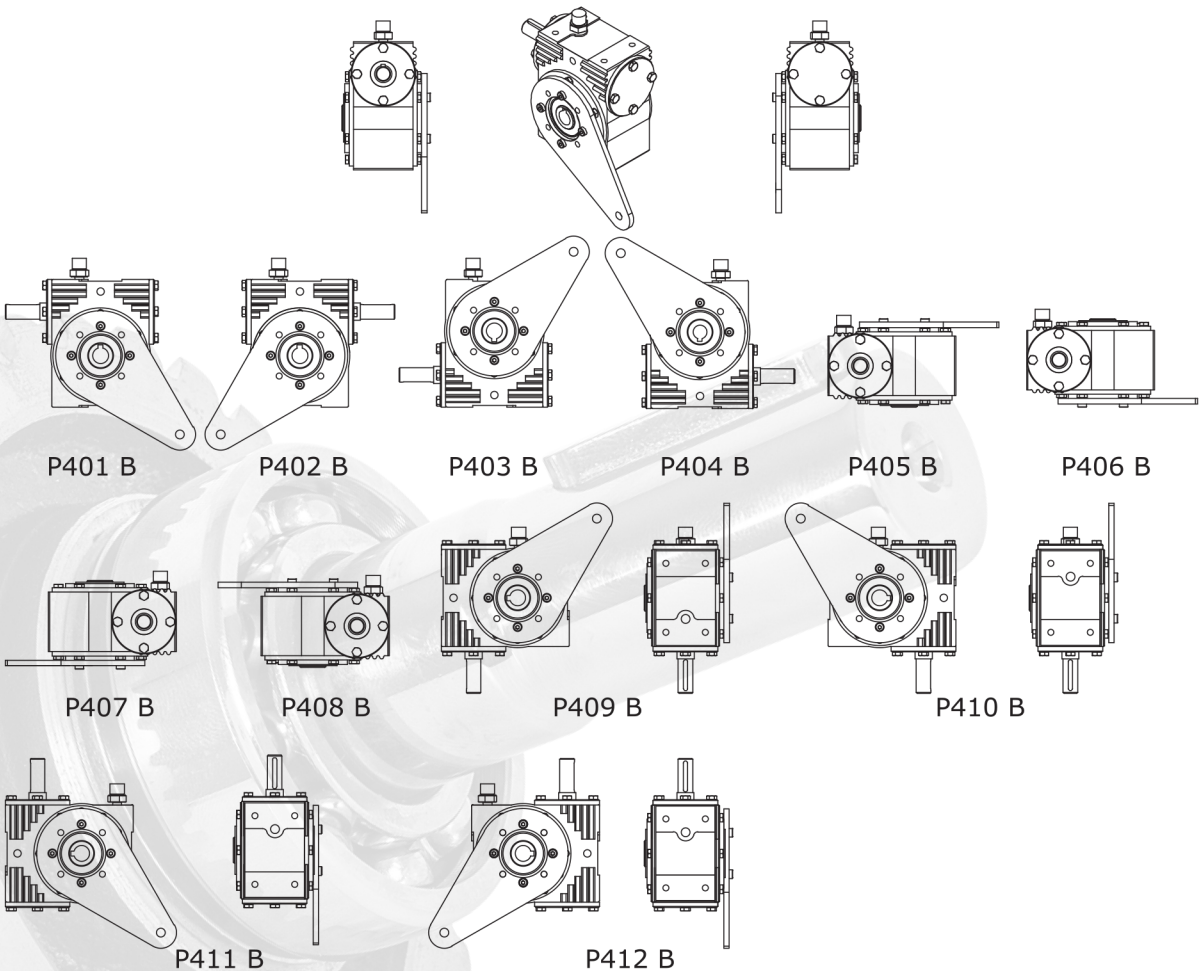

# FORMAS CONSTRUTIVAS PRA E PR

## EIXO DE SAÍDA NORMAL COM FLANGE DE SAÍDA

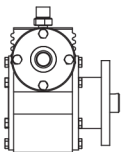
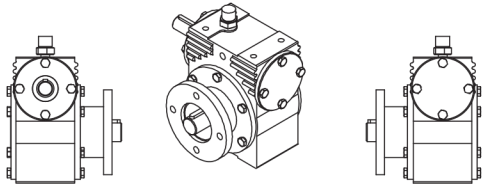

P401 D

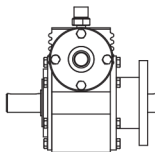

P401 DD

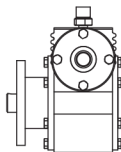

P402 E

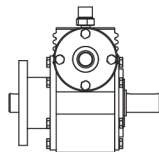

P402 DD

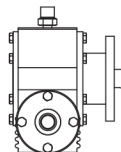

P403 D

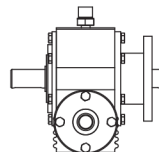

P403 DD

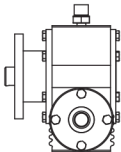

P404 E

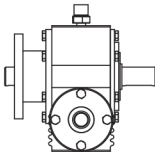

P404 DD

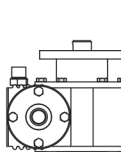

P405 D

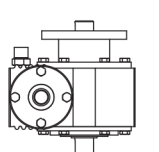

P405 DD

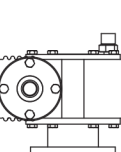

P406 D

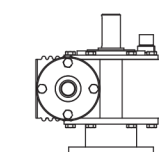

P406 DD

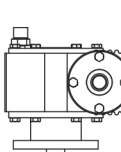

P407 D

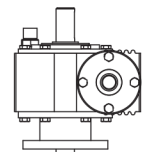

P407 DD

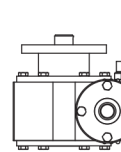

P408 E

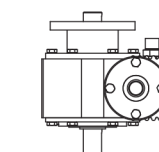

P408 DD

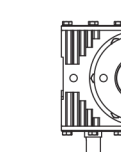

P409 D

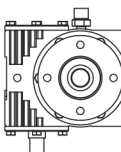
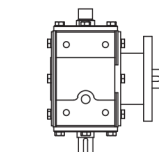

P409 DD

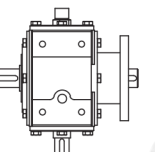

P410 E

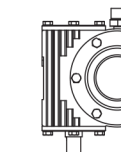

P410 DD

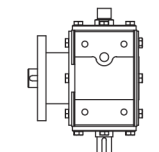

P411 D

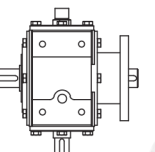

P411 DD

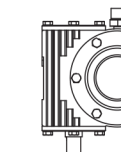

P412 E

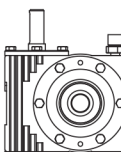
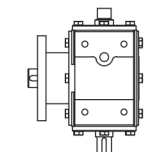

P412 DD

## FORMAS CONSTRUTIVAS PRA E PR

### EIXO DE SAÍDA VAZADO COM FLANGE DE SAÍDA

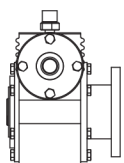
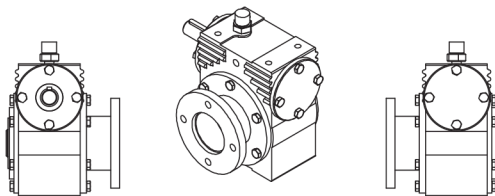

P401 V

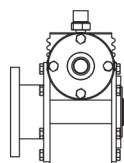

P402 V

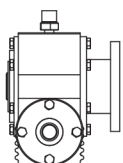

P403 V

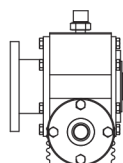

P404 V

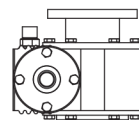

P405 V

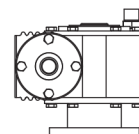

P406 V

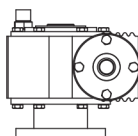

P407 V

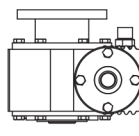

P408 V

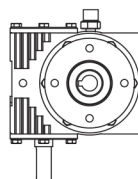

P409 V

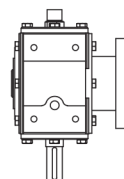

P410 V

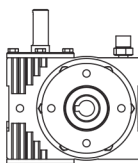

P411 V

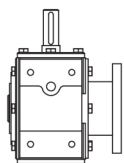

P412 V

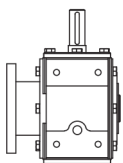
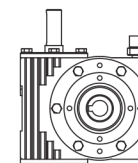

Todas as formas construtivas descritas se apresentam também para o flange e luneta de entrada, acrescentando na forma construtiva o F, para o flange de entrada e o L para a luneta.

#### FLANGE DE ENTRADA

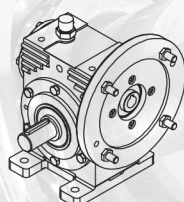

Exemplo: PF101E

#### LUNETAS DE ENTRADA

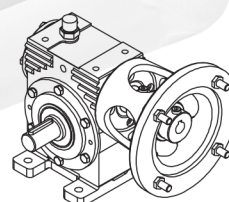

Exemplo: PL101E

# REDUTOR

PR

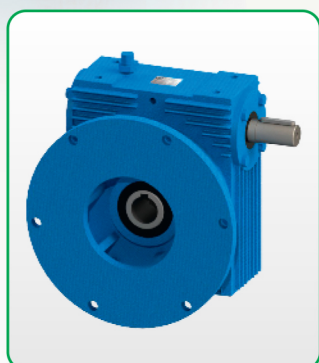
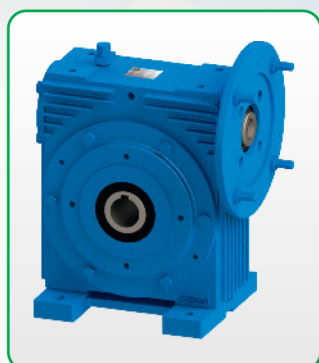
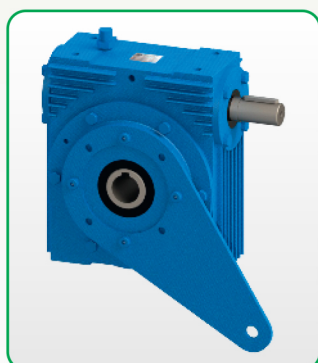

Linha tradicional de redutores em carcaça de ferro fundido com transmissão Coroa/Sem Fim, foram projetados para trabalhos de média e de alta solicitação, disponibilizando reduções de 1:7,5 até 1:100 em equipamentos de médio e grande porte.

Os redutores PRA-03, PRA-04 e PR-05 estão disponíveis na linha de alumínio e ferro fundido.

## TABELA DE POTÊNCIA DE ENTRADA E TORQUE DE SAÍDA

MODELO	RED.	MOTOR 4 PÓLOS - 60 Hz				MOTOR 6 PÓLOS - 60 Hz				MOTOR 8 PÓLOS - 60 Hz			
		Pe ( cv )	MT (Nm)	RPM ENTRADA	RPM SAÍDA	Pe ( cv )	MT (Nm)	RPM ENTRADA	RPM SAÍDA	Pe ( cv )	MT (Nm)	RPM ENTRADA	RPM SAÍDA
PR - 05	7,5	5	108,50	1700	226,67	4	128,31	1150	153,33	3	130,18	850	113,33
	10	5	144,70	1700	170	4	171,09	1150	115	3	173,54	850	85
	15	5	217	1700	113,33	3	192,47	1150	76,67	2	173,54	850	56,67
	20	3	173,54	1700	85	3	256,63	1150	57,5	2	231,42	850	42,5
	25	3	217	1700	68	2	213,86	1150	46	2	289,30	850	34
	30	3	260,36	1700	56,67	2	256,63	1150	38,33	1,5	260,36	850	28,33
	40	2	231,42	1700	42,5	2	342,17	1150	28,75	1,5	347,18	850	21,25
	50	1,5	217	1700	34	1,5	320,79	1150	23	1	289,30	850	17
	60	1,5	260,36	1700	28,33	1	256,63	1150	19,17	0,75	260,36	850	14,17
	80	1	231,42	1700	21,25	0,75	256,63	1150	14,38	0,50	231,42	850	10,63
PR - 06	7,5	6	130,18	1700	226,67	5	160,39	1150	153,33	4	173,54	850	113,33
	10	6	173,54	1700	170	5	213,86	1150	115	4	231,42	850	85
	15	6	260,36	1700	113,33	5	320,79	1150	76,67	4	347,18	850	56,67
	20	5	289,30	1700	85	4	342,17	1150	57,5	3	347,18	850	42,5
	25	5	361,60	1700	68	4	427,62	1150	46	3	434	850	34
	30	5	433,90	1700	56,67	3	384,94	1150	38,33	3	520,71	850	28,33
	40	4	462,84	1700	42,5	3	513,16	1150	28,75	2	462,84	850	21,25
	50	3	434	1700	34	2	427,62	1150	23	2	578,59	850	17
	60	2	347,18	1700	28,33	1,5	384,94	1150	19,17	1,5	520,71	850	14,17
	80	1,5	347,18	1700	21,25	1	342,17	1150	14,38	1	462,84	850	10,63
PR - 07	10	7,5	217	1700	170	6	256,63	1150	115	6	347,18	850	85
	15	7,5	325,50	1700	113,33	6	384,94	1150	76,67	6	520,71	850	56,67
	20	7,5	434	1700	85	6	513,16	1150	57,5	5	578,59	850	42,5
	25	6	434	1700	68	5	534,55	1150	46	4	578,59	850	34
	30	6	520,71	1700	56,67	5	641,48	1150	38,33	4	694,35	850	28,33
	40	5	578,59	1700	42,5	4	684,25	1150	28,75	3	694,35	850	21,25
	50	4	578,59	1700	34	3	641,48	1150	23	3	867,89	850	17
	60	3	520,71	1700	28,33	2	513,16	1150	19,17	2	694,35	850	14,17
PR - 08	15	15	651	1700	113,33	10	641,38	1150	76,67	7,5	650,79	850	56,67
	20	12,5	723,29	1700	85	7,5	641,48	1150	57,5	7,5	867,89	850	42,5
	30	10	867,89	1700	56,67	6	769,79	1150	38,33	5	867,99	850	28,33
	40	10	1157,19	1700	42,5	5	855,24	1150	28,75	5	1157,19	850	21,25
	50	7,5	1084,89	1700	34	5	1069,09	1150	23	4	1157,19	850	17
	60	6	1041,63	1700	28,33	3	769,59	1150	19,17	3	1041,23	850	14,17
	80	4	925,77	1700	21,25	2	683,95	1150	14,38	2	925,28	850	10,63
PR - 09	15	20	867,89	1700	113,33	15	962,16	1150	76,67	12,5	1084,79	850	56,67
	20	20	1157,19	1700	85	12,5	1069,09	1150	57,5	12,5	1446,48	850	42,5
	30	15	1301,79	1700	56,67	10	1283,05	1150	38,33	7,5	1301,98	850	28,33
	40	12,5	1446,48	1700	42,5	7,5	1282,95	1150	28,75	7,5	1735,78	850	21,25
	50	10	1446,48	1700	34	7,5	1603,74	1150	23	6	1735,78	850	17
	60	10	1735,98	1700	28,33	6	1539,29	1150	19,17	5	1735,39	850	14,17
	80	6	1388,60	1700	21,25	4	1368	1150	14,38	3	1387,92	850	10,63
PR - 10	20	25	1446,48	1700	85	20	1710,57	1150	57,5	15	1735,78	850	42,5
	30	20	1735,68	1700	56,67	15	1924,62	1150	38,33	15	2603,97	850	28,33
	40	15	1735,78	1700	42,5	12,5	2138,29	1150	28,75	12,5	2892,97	850	21,25
	50	15	2169,68	1700	34	12,5	2672,83	1150	23	10	2892,97	850	17
	60	12,5	2169,97	1700	28,33	10	2565,51	1150	19,17	7,5	2603,08	850	14,17
	80	7,5	1735,78	1700	21,25	7,5	2565,02	1150	14,38	6	2775,94	850	10,63
	100	6	1735,78	1700	17	6	2565,90	1150	11,50	5	2892,97	850	8,5

**OBS.:** Aplicar a potência indicada para cada redução somente se a rotação de entrada no redutor for a mesma da saída do motor. Se houver necessidade de se obter novas reduções, sempre optar em fazer na saída do redutor, e não na entrada.

- CV = kW X 1,358
- kW = HP X 0,736
- Nm = Kgm X 9,81
- Kgm = Nm X 0,102

## REDUTOR NORMAL

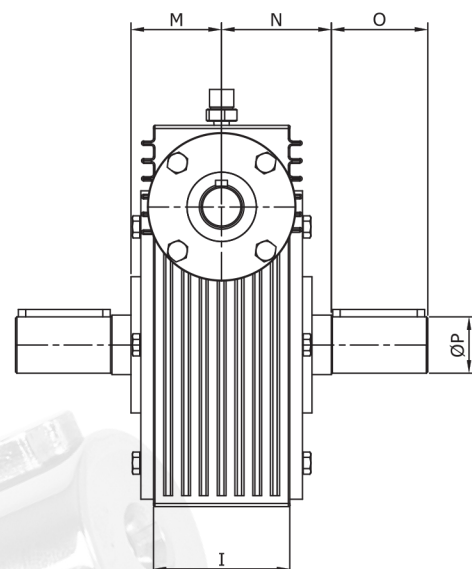
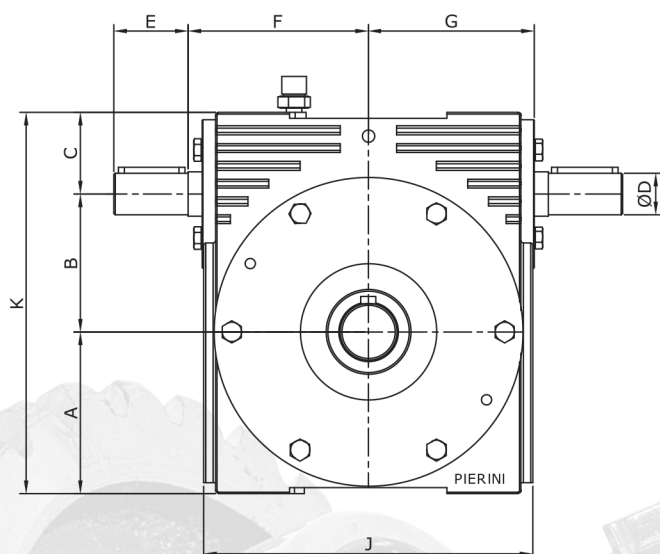
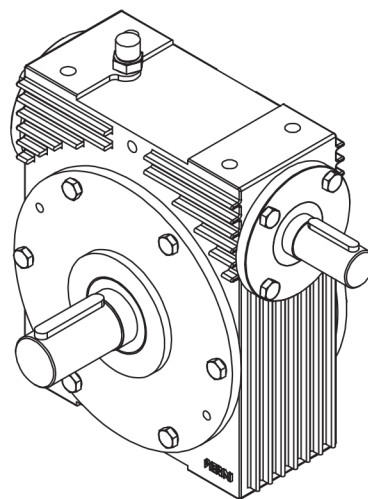
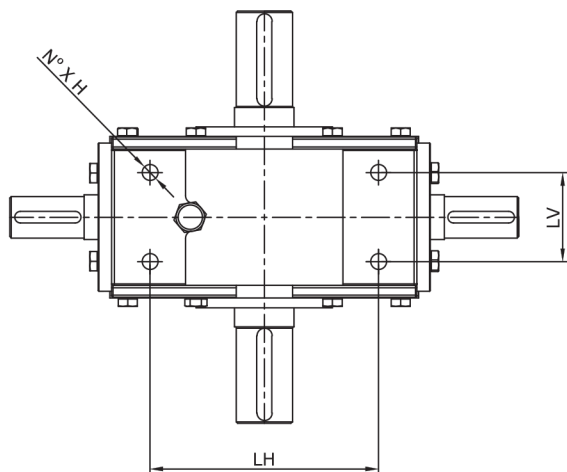

MODELO	A	B	C	ØD	E	F	G	I	J	K	LH	LV	M	N	N° x H	O	ØP
PR - 05	109	93	55	28	50	121,5	112	92	228	257	154	60	61	74	4 X M12	65	38
PR - 06	125	113	63	32	60	140,25	132	112	261	301	192	76	75	80	4 X M14	70	44
PR - 07	154	133	66	35	70	171,25	160	122	315	353	240	85	78	86	4 X M14	70	48
PR - 08	173	160	72	40	65	202,75	183	147	352	405	301	100	87,5	96,5	4 X M14	80	50
PR - 09	199	190	82	40	70	234,75	214	166	414	471	328	116	100	112	4 X M16	90	60
PR - 10	229	215	87	45	75	261	236,75	176	455,5	531	378	125	110	119	4 X M18	100	65

**OBS.:** Para outras opções de medida ØP, entrar em contato com a Pierini Redutores.

Os valores apresentados estão sujeitos à alteração sem aviso prévio.



## REDUTOR VAZADO

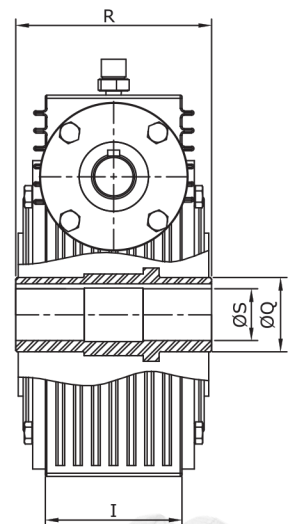
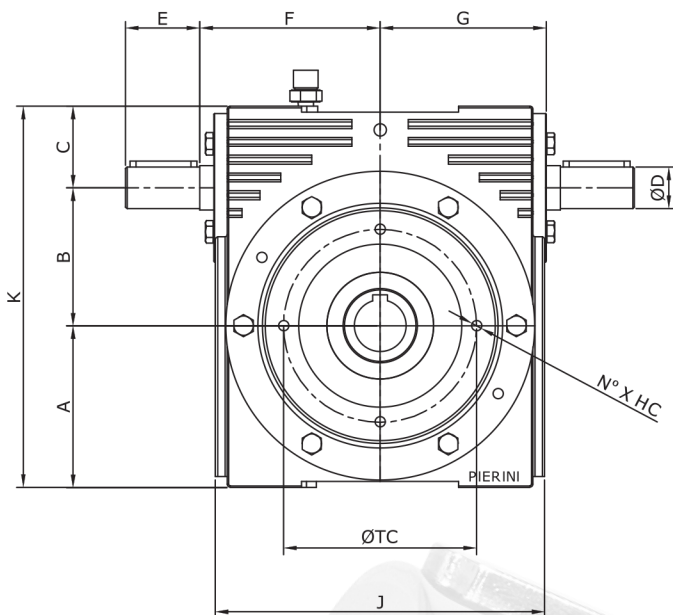
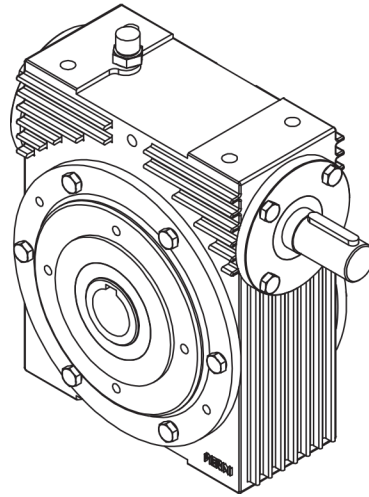
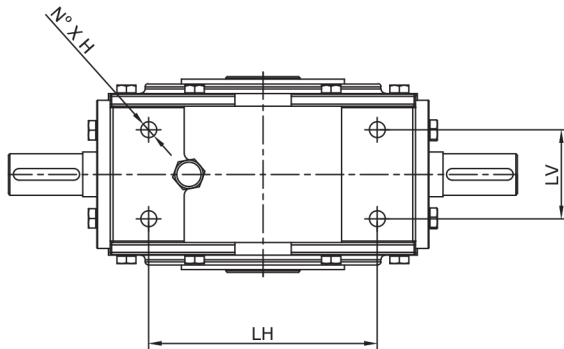

MODELO	A	B	C	ØD	E	F	G	I	J	K	LH	LV	N° x H	N° x HC	ØQ	R	ØS	ØTC
PR - 05	109	93	55	28	50	121,5	112	92	228	257	154	60	4 X M12	4 X M8	50	132	35	130
PR - 06	125	113	63	32	60	140,25	132	112	261	301	192	76	4 X M14	6 X M8	55	155,4	40	150
PR - 07	154	133	66	35	70	171,25	160	122	315	353	240	85	4 X M14	6 X M8	65	168	45	168
PR - 08	173	160	72	40	65	202,75	183	147	352	405	301	100	4 X M14	—	70	181	48	—
PR - 09	199	190	82	40	70	234,75	214	166	414	471	328	116	4 X M16	—	80	208	55	—
PR - 10	229	215	87	45	75	261	236,75	176	455,5	531	378	125	4 X M18	—	90	228	60	—

**OBS.:** Para outras opções de medida ØS, entrar em contato com a Pierini Redutores.

A tampa do eixo de saída com rosca N° x HC, deve ser solicitada na hora da compra.

Para os redutores PR-06 e PR-07 a furação da tampa da coroa vazada 'N° x HC' é com 6 furos de 60°.

Os valores apresentados estão sujeitos à alteração sem aviso prévio.

## REDUTOR COM PÉS HORIZENTAIS EIXO NORMAL

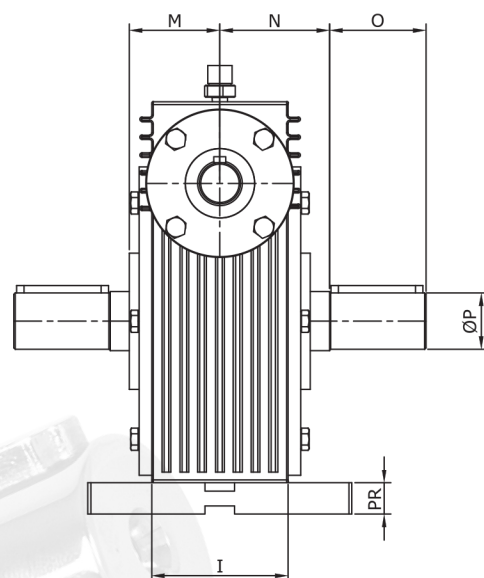
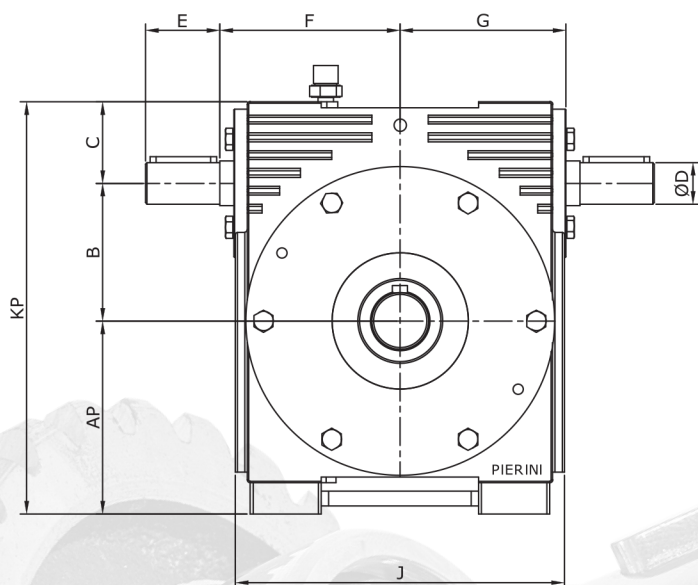
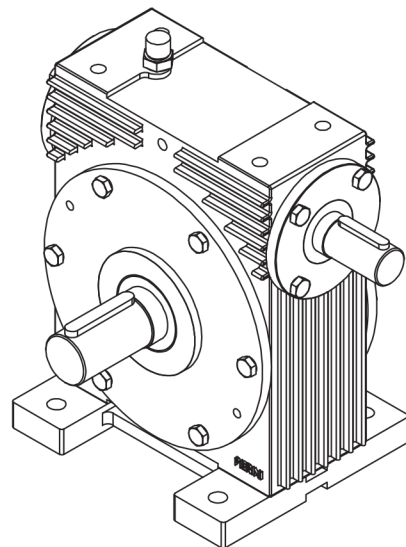
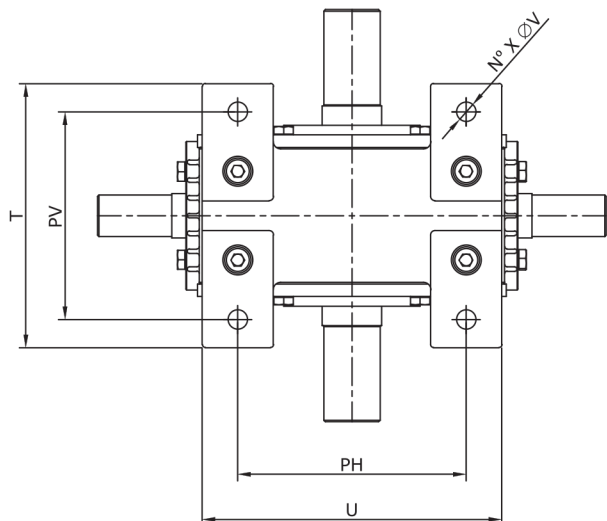

MODELO	AP	B	C	ØD	E	F	G	I	J	KP	M	N	N° X ØV	O	ØP	PH	PR	PV	T	U
PR - 05	130	93	55	28	50	121,5	112	92	228	278	61	74	4 X 13	65	38	154	21	140	178	202
PR - 06	151	113	63	32	60	140,25	132	112	261	327	75	80	4 X 16	70	44	192	26	164	208	240
PR - 07	180	133	66	35	70	171,25	160	122	315	379	78	86	4 X 17	70	48	240	26	180	224	295
PR - 08	200	160	72	40	65	202,75	183	147	352	432	87,5	96,5	4 X 19	80	50	280	27	195	253	338
PR - 09	227	190	82	40	70	234,75	214	166	414	499	100	112	4 X 20	90	60	328	28	220	286	388
PR - 10	260	215	87	45	75	261	236,75	176	455,5	562	110	119	4 X 20	100	65	373	31	245	320	440

**OBS.:** A fixação do redutor é feita por quatro roscas 'N° X ØV' indicada na tabela acima.

Para outras opções de medida ØP, entrar em contato com a Pierini Redutores.

Os valores apresentados estão sujeitos à alteração sem aviso prévio.

## REDUTOR COM PÉS HORIZONTAIS EIXO VAZADO

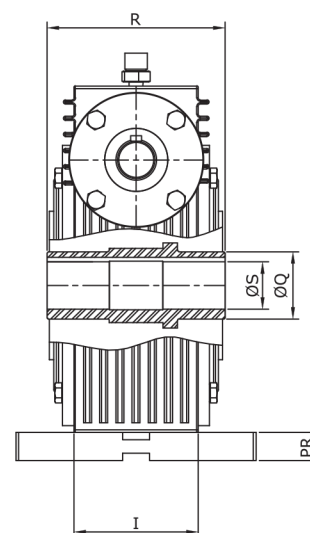
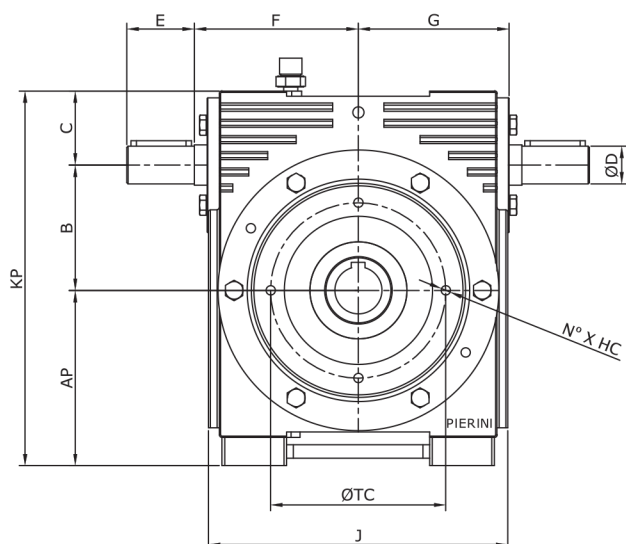
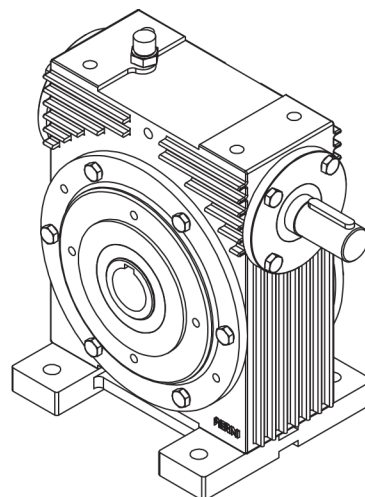
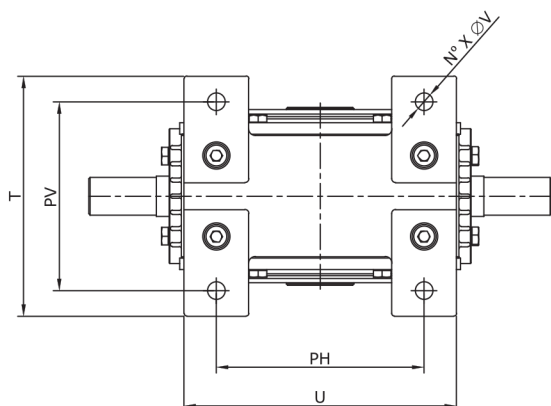

MODELO	AP	B	C	ØD	E	F	G	I	J	KP	N° X HC
PR - 05	130	93	55	28	50	121,5	112	92	228	278	4 X M8
PR - 06	151	113	63	32	60	140,25	132	112	261	327	6 X M8
PR - 07	180	133	66	35	70	171,25	160	122	315	379	6 X M8
PR - 08	200	160	72	40	65	202,75	183	147	352	432	—
PR - 09	227	190	82	40	70	234,75	214	166	414	499	—
PR - 10	260	215	87	45	75	261	236,75	176	455,5	562	—

MODELO	N° X ØV	PH	PR	PV	ØQ	R	ØS	T	ØTC	U
PR - 05	4 X 13	154	21	140	50	132	35	178	130	202
PR - 06	4 X 16	192	26	164	55	155,4	40	208	150	240
PR - 07	4 X 17	240	26	180	65	168	45	224	168	295
PR - 08	4 X 19	280	27	195	70	181	48	253	—	338
PR - 09	4 X 20	328	28	220	80	208	55	286	—	388
PR - 10	4 X 20	373	31	245	90	228	60	320	—	440

**OBS.:** A fixação do redutor é feita por quatro roscas 'N° X ØV' indicada na tabela acima.

Para outras opções de medida ØS, entrar em contato com a Pierini Redutores.

A tampa do eixo de saída com rosca N° x HC, deve ser solicitada na hora da compra.

Para os redutores PR-06 e PR-07 a furação da tampa da coroa vazada 'N° x HC' é com 6 furos de 60°.

Os valores apresentados estão sujeitos à alteração sem aviso prévio.

## REDUTOR COM BRAÇO TORÇOR

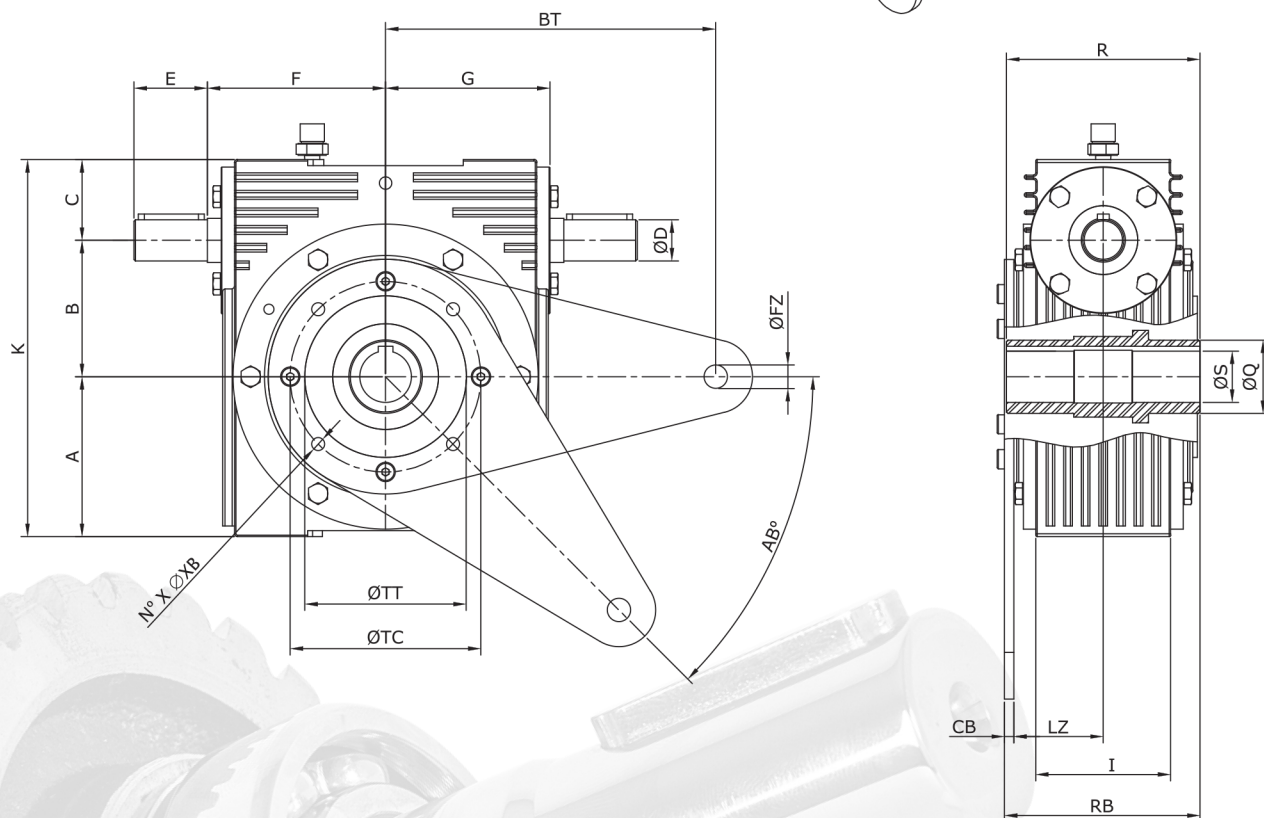
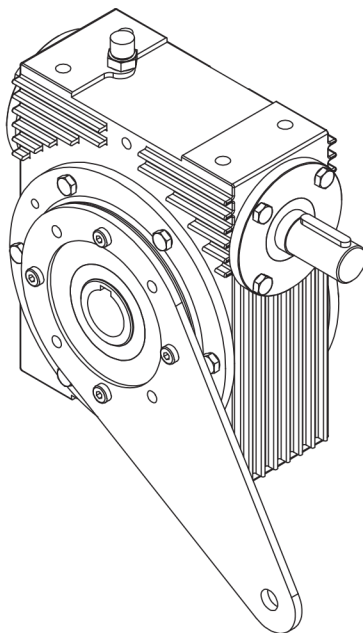

MODELO	A	AB°	B	BT	C	CB	ØD	E	F	ØFZ	G	I	K	LZ	N° X ØXB	ØQ	R	RB	ØS	ØTC	ØTT
PR-05	109	45°	93	225	55	6,35	28	50	121,5	16	112	92	257	61	8 X 9	50	132	133,35	35	130	110
PR-06	125	60°	113	270	63	9,52	32	60	140,25	16	132	112	301	71,5	6 X 9	55	155,4	158,72	40	150	100
PR-07	154	60°	133	300	66	9,52	35	70	171,25	16	160	122	353	77	6 X 9	65	168	170,52	45	168	104

**OBS.:** Para outras opções de medida ØS, entrar em contato com a Pierini Redutores.

Para os redutores PR-06 e PR-07 a furação do braço torçor 'N° x ØXB' é com 6 furos de 60°.

Os redutores PR-08, PR-09 e PR-10 não são fornecidos com braço torçor.

Os valores apresentados estão sujeitos à alteração sem aviso prévio.

## REDUTOR COM FLANGE DE SAÍDA EIXO NORMAL

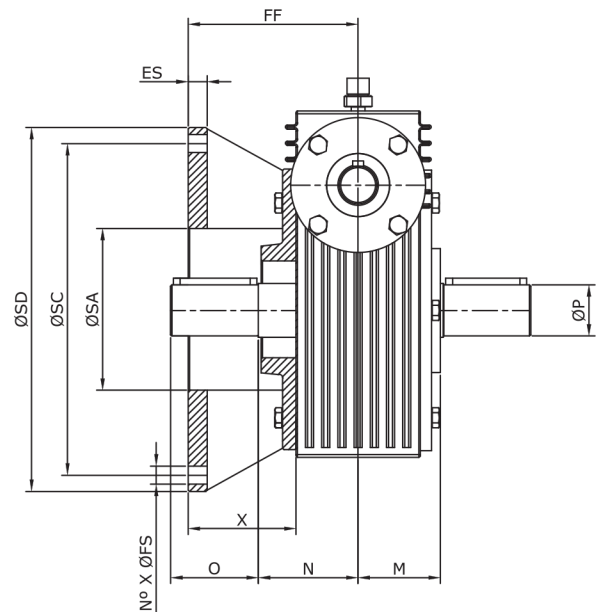
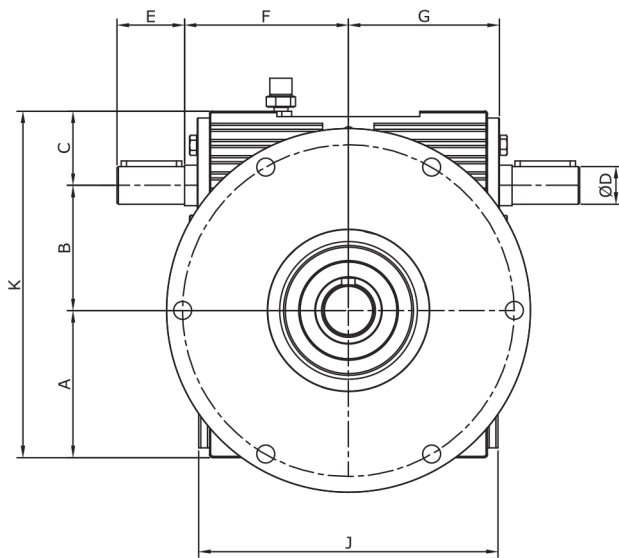
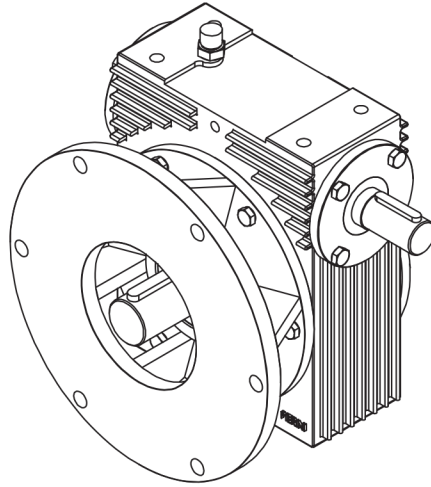

MODELO	A	B	C	Ø D	E	ES	F	FF	G	J	K	M	N	Nº X ØFS	O	ØP	ØSA	ØSC	ØSD	X
PR-05	109	93	55	28	50	14	121,5	126	112	228	257	61	74	6 X 13,5	65	38	120	246	270	80
PR-06	125	113	63	32	60	17	140,25	140	132	261	301	75	80	6 X 13,5	70	44	165	260	295	84
PR-07	154	133	66	35	70	19	171,25	145	160	315	353	78	86	6 X 14	70	48	160	265	295	84
PR-08	173	160	72	40	65	20	202,75	179,5	183	352	405	87,5	96,5	8 X 15	80	50	200	306	340	106
PR-09	199	190	82	40	70	23	234,75	193	214	414	471	100	112	10 X 16	90	60	250	356	395	110
PR-10	229	215	87	45	75	25	261	203	236,75	455,5	531	110	127	12 X 17	100	65	300	410	450	115

**OBS.:** Para outras opções de medida  $\varnothing P$ , entrar em contato com a Pierini Redutores.

Para o redutor PR-08 a furação do flange de saída 'NºXØFS' é com 8 furos de 45°.

Para o redutor PR-09 a furação do flange de saída 'NºXØFS' é com 10 furos de 36°.

Para o redutor PR-10 a furação do flange de saída 'NºXØFS' é com 12 furos de 30°.

Os valores apresentados estão sujeitos à alteração sem aviso prévio.

## REDUTOR COM FLANGE DE SAÍDA EIXO VAZADO

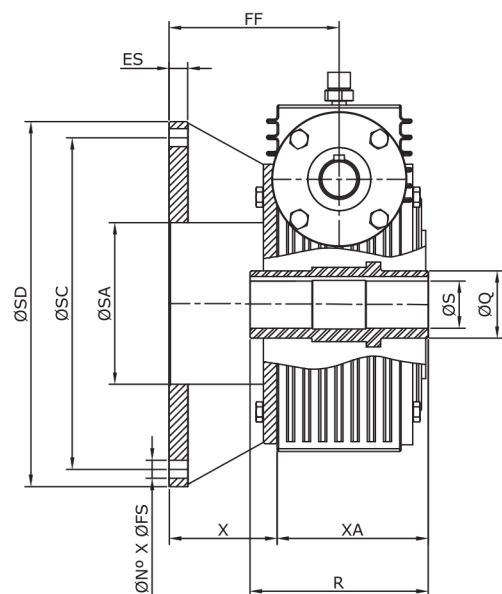
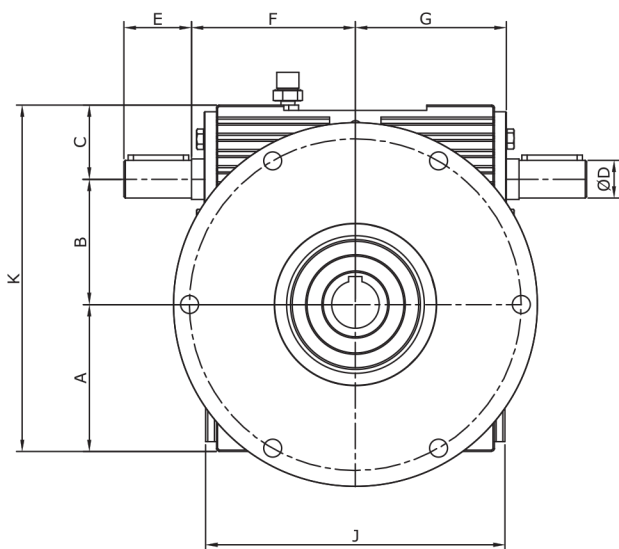
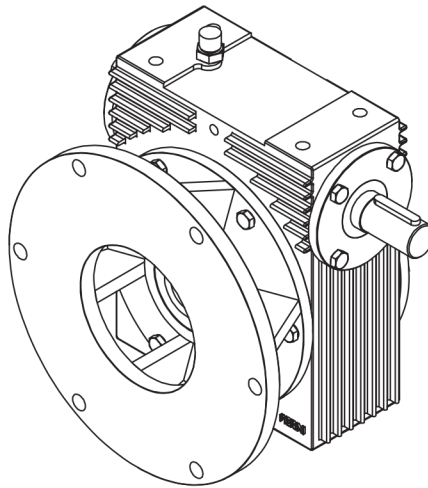

MODELO	A	B	C	Ø D	E	ES	F	FF	G	J	K	Nº X ØFS	ØQ	R	ØS	ØSA	ØSC	ØSD	X	XA
PR-05	109	93	55	28	50	14	121,5	126	112	228	257	6 X 13,5	50	140	35	120	246	270	80	112
PR-06	125	113	63	32	60	17	140,25	140	132	261	301	6 X 13,5	55	161,4	40	165	260	295	84	133,7
PR-07	154	133	66	35	70	19	171,25	145	160	315	353	6 X 14	65	168	45	160	265	295	84	145
PR-08	173	160	72	40	65	20	202,75	179,5	183	352	405	8 X 15	70	191	48	200	306	340	106	164
PR-09	199	190	82	40	70	23	234,75	193	214	414	471	10 X 16	80	224	55	250	356	395	110	187
PR-10	229	215	87	45	75	25	261	203	236,75	455,5	531	12 X 17	90	242	60	300	410	450	115	202

**OBS.:** Para outras opções de medida ØS, entrar em contato com a Pierini Redutores.

Para o redutor PR-08 a furação do flange de saída 'N°XØFS' é com 8 furos de 45°.

Para o redutor PR-09 a furação do flange de saída 'N°XØFS' é com 10 furos de 36°.

Para o redutor PR-10 a furação do flange de saída 'N°XØFS' é com 12 furos de 30°.

Os valores apresentados estão sujeitos à alteração sem aviso prévio.

## REDUTOR COM FLANGE DE ENTRADA

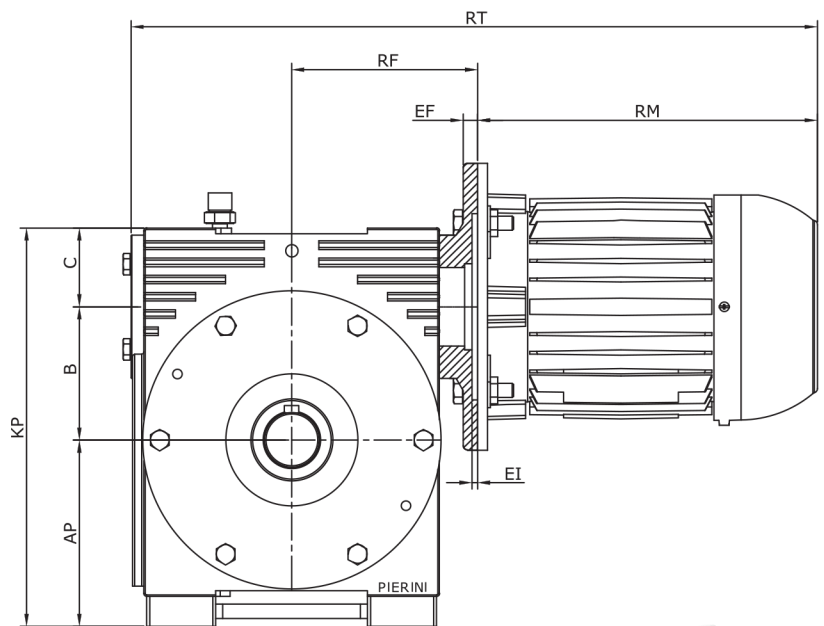
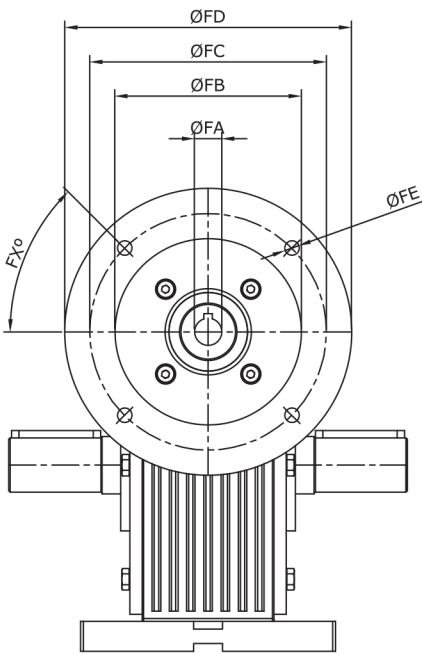
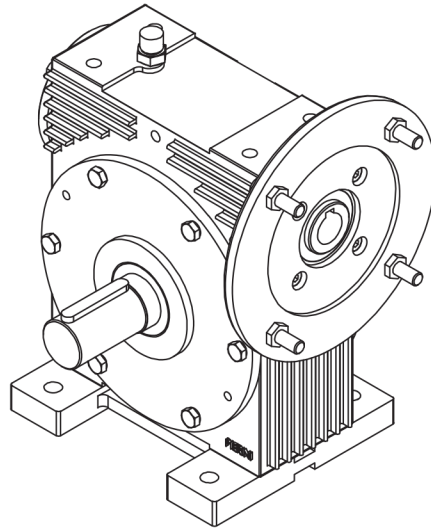

MODELO	CARCAÇA - MOTOR	FLANGE	AP	B	C	EF	EI	ØFA	ØFB	ØFC	ØFD	ØFE	FX°	KP	RF	RM	RT
PR-05	80 - 1 e 1,5cv	B14	130	93	55	9	3,5	19	80	100	120	6,5	0°	278	129,25	237	478,25
	90 - 2cv	B14				24		95	115	140	9	255	496,25				
	90 - 3cv	B14				28		110	130	160		280	521,25				
	100 - 4 e 5cv	B14				14		110	130	160		316,1	558,35				
	71 - 3/4cv	B5				129,75	19	130	165	200		12	219		460,75		
	80 - 1 e 1,5cv	B5					10	4	19	130	165	200	12		237	478,75	
	90 - 2cv	B5					24	130	165	200	12	255	496,75				
	90 - 3cv	B5					28	130	165	200	12	280	521,75				
100 - 4 e 5cv	B5	16	4,5	28	180	215	250	15	130,25	316,1	558,35						
PR-06	80 - 1 e 1,5cv	B5	151	113	63	11	4	19	130	165	200	12	45°	327	148,5	237	517,5
	90 - 2cv	B5				24		130								165	200
	90 - 3cv	B5				150	14	4,5	28	180	215	250			15	280	560,5
	100 - 4 e 5cv	B5					316,1	598,1									
	112 - 6 e 7,5cv	B5					334,1	616,1									
PR-07	90 - 2cv	B5	180	133	66	11	4	24	130	165	200	12	45°	379	176	255	591
	90 - 3cv	B5				280		616									
	100 - 4 e 5cv	B5				316,1	652,1										
	112 - 6 e 7,5cv	B5				334,1	670,1										

OBS.: Os valores apresentados estão sujeitos à alteração sem aviso prévio.

# REDUTOR COM LUNETETA DE ENTRADA

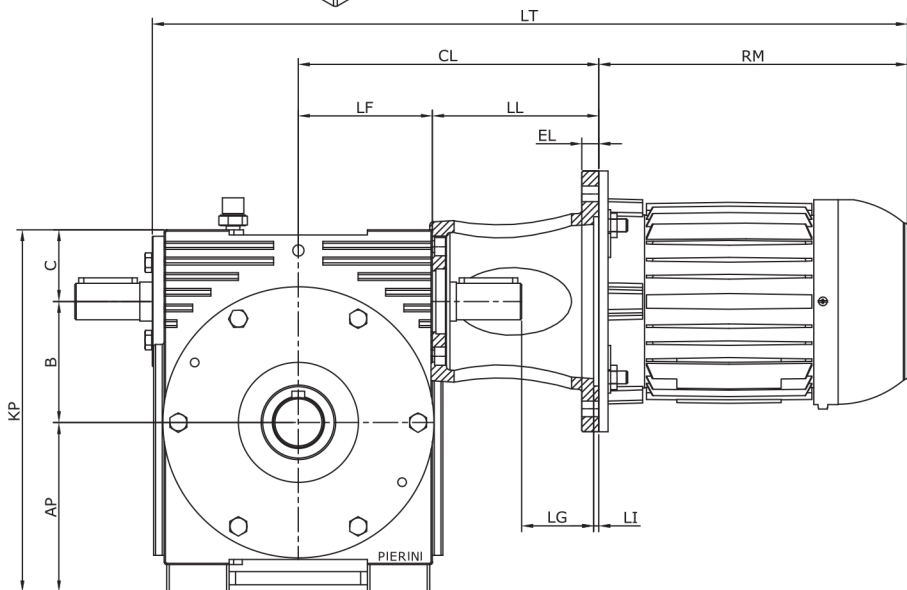
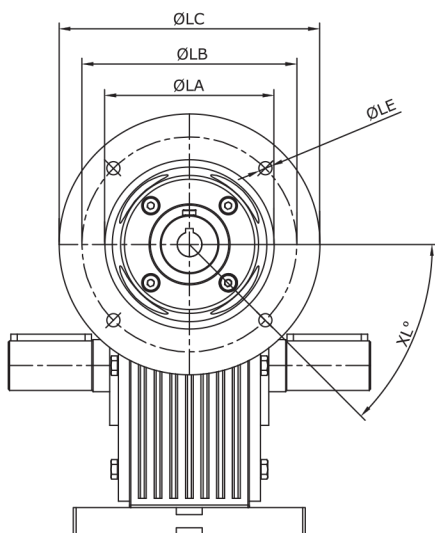
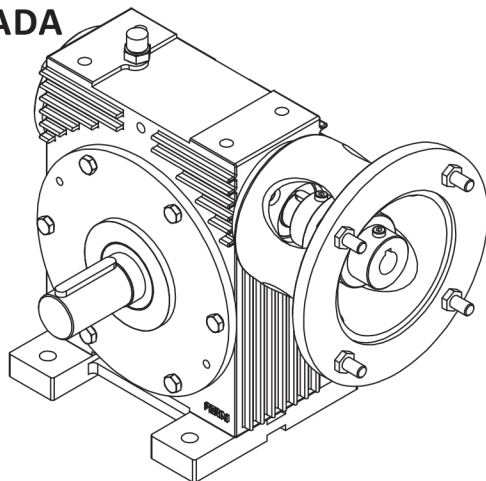

MODELO	CARCAÇA - MOTOR	FLANGE	AP	B	C	CL	EL	KP	ØLA	ØLB	ØLC	ØLE	LF	LG	LI	LL	LT	RM	XL°
PR-05	80 - 1 e 1,5cv	B5	130	93	55	230,75	13	278	130	165	200	12	103	55,25	4	127,75	579,75	237	45°
	90 - 2cv	B5				244,75								69,25		141,75	611,75	255	
	90 - 3cv	B5				260,75								84,75		157,75	636,75	280	
	100 - 4 e 5cv	B5				260,75								84,75		157,75	688,85	316,1	
PR-06	80 - 1 e 1,5cv	B5	151	113	63	263,25	13	327	130	165	200	12	122	59	4	141,25	632,25	237	45°
	90 - 2cv	B5				273								68,75		151	660	255	
	90 - 3cv	B5				289								84,25		167	685	280	
	100 - 4 e 5cv	B5				289								84,25		167	737,1	316,1	
PR-07	112 - 6 e 7,5cv	B5	180	133	66	314	13	379	130	165	200	12	150	68,75	4	164	729	255	45°
	90 - 2cv	B5				330								84,25		180	806,1	316,1	
	90 - 3cv	B5				330								84,25		180	824,1	334,1	
	100 - 4 e 5cv	B5				330								84,25		180	824,1	334,1	
PR-08	112 - 6 e 7,5cv	B5	200	160	72	340,5	15	432	130	165	222	15	174	69,25	3,5	166,5	803,5	280	45°
	90 - 3cv	B5				357,75								85,5		183,75	856,85	316,1	
	100 - 4 e 5cv	B5				357,75								85,5		183,75	874,85	334,1	
	112 - 6 e 7,5cv	B5				380,75								108		206,75	935,45	371,7	
PR-09	132 - 10cv	B5	227	190	82	394,75	18	499	180	215	250	15	202	85,5	4,5	192,75	924,85	316,1	45°
	100 - 4 e 5cv	B5				417,75								108		215,75	942,85	334,1	
	112 - 6 e 7,5cv	B5				417,75								108		215,75	1003,45	371,7	
	132 - 10cv	B5				417,75								108		215,75	1041,55	409,8	
PR-10	112 - 15cv	B5	260	215	87	424	18	562	180	215	295,5	15	224,75	83,5	4,5	199,25	994,85	334,1	45°
	132 - 6 e 7,5cv	B5				448								107		223,25	1056,45	371,7	
	132 - 10cv	B5				448								107		223,25	1094,55	409,8	
	132 - 12,5cv	B5				448								107		223,25	1119,25	434,5	
	160 - 20cv	B5				496,75								154,75		272	1221,75	488,25	
160 - 25cv	B5	496,75	154,75	272	1266,15	532,65													

OBS.: Os valores apresentados estão sujeitos à alteração sem aviso prévio.